

ANACOSTIA REALTY LLC  
6820B COMMERCIAL DR  
SPRINGFIELD VA 22151-4201

DISTRICT OF COLUMBIA  
1133 N CAPITOL ST NE  
WASHINGTON DC 20002-7561

GONZALES, MIGUEL P  
5700 COLORADO AVE NW  
WASHINGTON DC 20011-7806

IBIROGBA, ADERONKE  
1329 ALLISON ST NW  
WASHINGTON DC 20011-4440

BENITEZ, JESUS A  
1401 WEBSTER ST NW  
WASHINGTON DC 20011-7029

4406 14TH ST DEVELOPMENT LLC  
4406 14TH ST NW  
WASHINGTON DC 20011-7020

DISTRICT OF COLUMBIA  
2000 14TH ST NW 8TH FLOOR  
WASHINGTON DC 20009-4487

ANDRINGA, JULIE C  
1403 WEBSTER ST NW  
WASHINGTON DC 20011-7029

AREVALO, BLANCA S  
4500 14TH ST NW  
WASHINGTON DC 20011-4359

4403 14TH STREET NW LLC  
3628 12TH ST NE  
WASHINGTON DC 20017-2546

SMALL, LAURA B  
1405 WEBSTER ST NW  
WASHINGTON DC 20011-7029

WILSON, HENRY T  
4502 14TH ST NW  
WASHINGTON DC 20011-4359

4425 14TH ST LLC  
3628 12TH ST NE  
WASHINGTON DC 20017-2546

GIROUX, DAVID  
4420 14TH ST NW  
WASHINGTON DC 20011-7020

RE'ESE ADBARAT DEBRE SELAM KIDIST  
1350 BUCHANAN ST NW  
WASHINGTON DC 20011-4453

DBGMS, LLC  
1331 CONNECTICUT AVE NW  
WASHINGTON DC 20036-1801

DUCKETT, TAHIR A  
1355 SHEPHERD ST NW APT 3  
WASHINGTON DC 20011-5575

4331 14TH STREET LLC  
1331 CONN AVE NW  
WASHINGTON DC 20036-1801

ASSEFA, TSION  
9317 NEW HAMPSHIRE AVE  
SILVER SPRING MD 20903-2315

MURRAY H APPELBAUM TRUSTEE  
75 GLEN COVE DR  
CHESTERFIELD MO 63017-2754

ASEFA, MISS L  
4413 14TH ST NW  
WASHINGTON DC 20011-7019

GORDON, CONRAD  
4414 14TH ST NW  
WASHINGTON DC 20011-7020

ANGELINA E EMANUELE TRUSTEE  
10304 MONTGOMERY AVE  
KENSINGTON MD 20895-3327

PAGUADA, MIRIAN  
4412 14TH ST NW  
WASHINGTON DC 20011-7020

ALPHA KAPPA ALPHA SRRTY INC  
4411 14TH ST NW  
WASHINGTON DC 20011-7019

HOLMAN, ANNIE M  
4410 14TH ST NW  
WASHINGTON DC 20011-7020

ZONING COMMISSION

District of Columbia

CASE NO.22-12

Report Date: 6/6/2022 17C



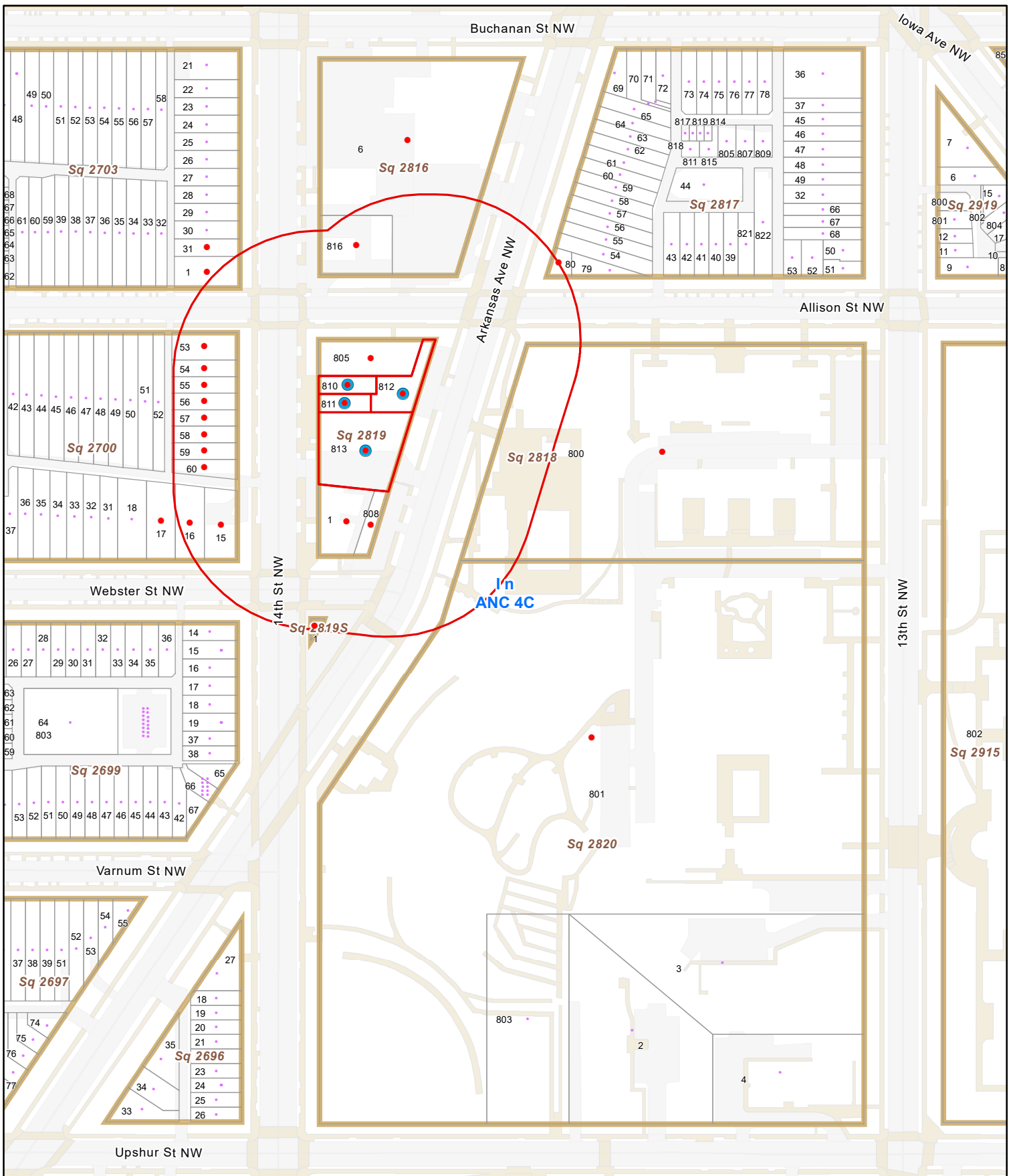

**Subject Property ID's:**  
**2819 0810, 0811, 0812, 0813**

- Subject Properties
- Radius
- Ownership Lots
- DC Squares
- ANC Boundary

★ ★ ★ DC Office of Tax and Revenue  
★ ★ ★ Real Property Assessment Division  
★ ★ ★ Maps and Titles Assessment Roll  
★ ★ ★ Geographic Information Systems

1:2,123  
 0 50  
 Feet

Print Date: 6/6/2022  
 For general planning purposes

